

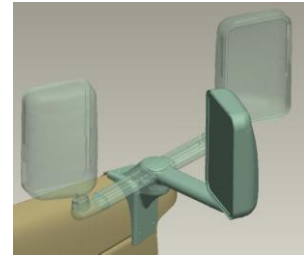

For More Information  
Contact: Karen Leix  
Marketing Communications Manager  
kleix@velvac.com



*For Immediate Release*

## **Velvac Announces New Shuttle Bus Mirror System** ***Leading Manufacturer of Vision Systems to Heavy and Medium Duty truck OEM's, Recreational and Specialty Vehicle Markets***

**November 2, 2009 – New Berlin, Wis.** Velvac, Inc. is pleased to announce the introduction of a new 2020SS mirror system for shuttle bus applications which combines the styling, durability and performance of our door mounted 2020 mirror, with our new, easy to install fender mounted 2020 mirror with a spring loaded pivot system. The mirror systems are available to fit both GM G-Van and Ford E-Van chassis in both 96" and 102" body widths with optional cameras, in-glass turn signal indicators, heated/remote for both flat and convex glass, adjustable home position and foldaway feature.

Velvac's engineers achieved class-leading visibility and glass stability through a series of innovative design features aimed at improving the rigidity of the mirror system as well as minimizing vibration. The mirror arm and base include a heavy walled die cast construction utilizing OE tested materials and finishes to withstand tough shuttle bus duty cycles and climates. The Velvac deluxe mirror head provides a wider flat glass and larger convex providing a 40% larger field of view compared to typical shuttle bus mirrors used today. The larger field of view and the outstanding stability allows the mirrors to provide a clear image of the blind spots and passing lanes around the vehicle leading to improved safety and faster driver reaction time.

Velvac's 2020SS mirror system is fast and easy to install. The left side door mirror fits directly into the OE "sail" patch area on the door. The right side fender mirror utilizes Velvac's new bracket mount system that attaches easily under the hood for a fast clean installation. The spring loaded pivot system on both the door and fender base allows the mirrors to be folded back, or fold back upon impact, and then return easily to the home viewing position. The aluminum mirror arms and bracket are e-coated then powder coated for long lasting corrosion and chip resistance. To provide an OEM appearance and protect the wiring, all wires are internally routed. To allow the driver easy access to the mirrors the Velvac mirror system includes a control switch housing on the "sail" patch of the driver's door.

**About Velvac, Inc.**

Velvac is a leading manufacturer and supplier of vision systems and component parts to the recreational, truck and specialty vehicle industries. Velvac has the industry's broadest mirror product offering, from unique, proprietary mirror systems for OEM vehicles to high-volume replacement mirror heads and service parts. Founded in 1934, Velvac's corporate offices and aftermarket operations are located in New Berlin, Wisconsin. Its complete state-of-the-art manufacturing facility is located in Reynosa, Mexico. In 2005, Velvac was acquired by Prospect Partners, LLC, a Chicago-based private equity firm specializing in lower-middle-market niche businesses, and Jeff Porter, Velvac President & CEO. For more information, visit the company's Web site at [www.velvac.com](http://www.velvac.com).