

NOTE: MIRROR HEAD CONFIG. MAY VARY.

REPLACEMENT CLASS "A" MIRROR HEAD INSTALLATION INSTRUCTIONS

INSTALLATION INSTRUCTIONS

TOOLS REQUIRED: 3/16" HEX WRENCH
WIRE CUTTERS
CRIMPING TOOL

WIRE COLOR	FUNCTION	WIRE COLOR	FUNCTION
YELLOW	(FLAT) COMMON	*BROWN	(CNVX) COMMON
BLACK	(FLAT) VERTICAL	*ORANGE	(CNVX) VERTICAL
WHITE	(FLAT) HORIZONTAL	*BLUE	(CNVX) HORIZONTAL
GRAY	TURN SIGNAL	RED	HEATER
PURPLE	TURN SIGNAL	GREEN	HEATER

*NOTE: BROWN,ORANGE,BLUE WIRES FOR CONVEX REMOTE MIRROR ONLY.

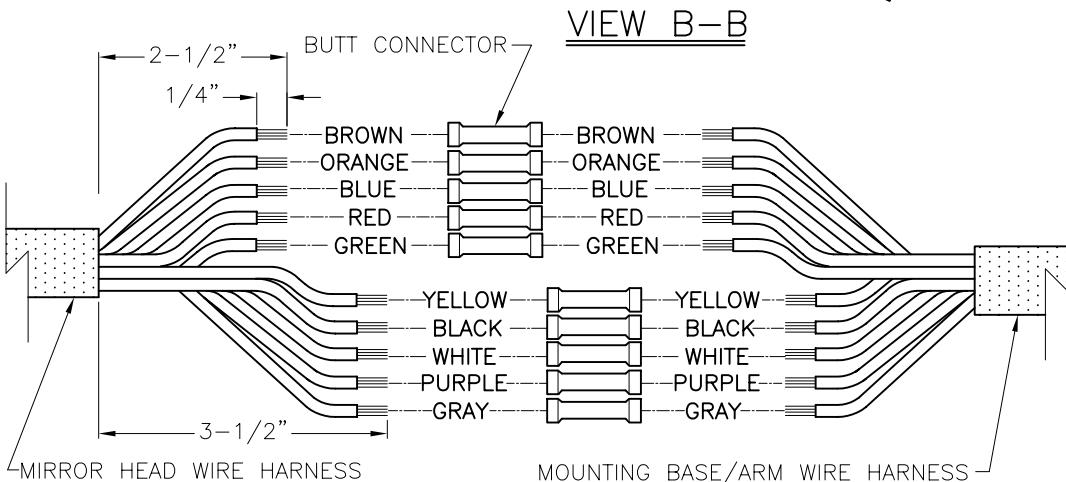
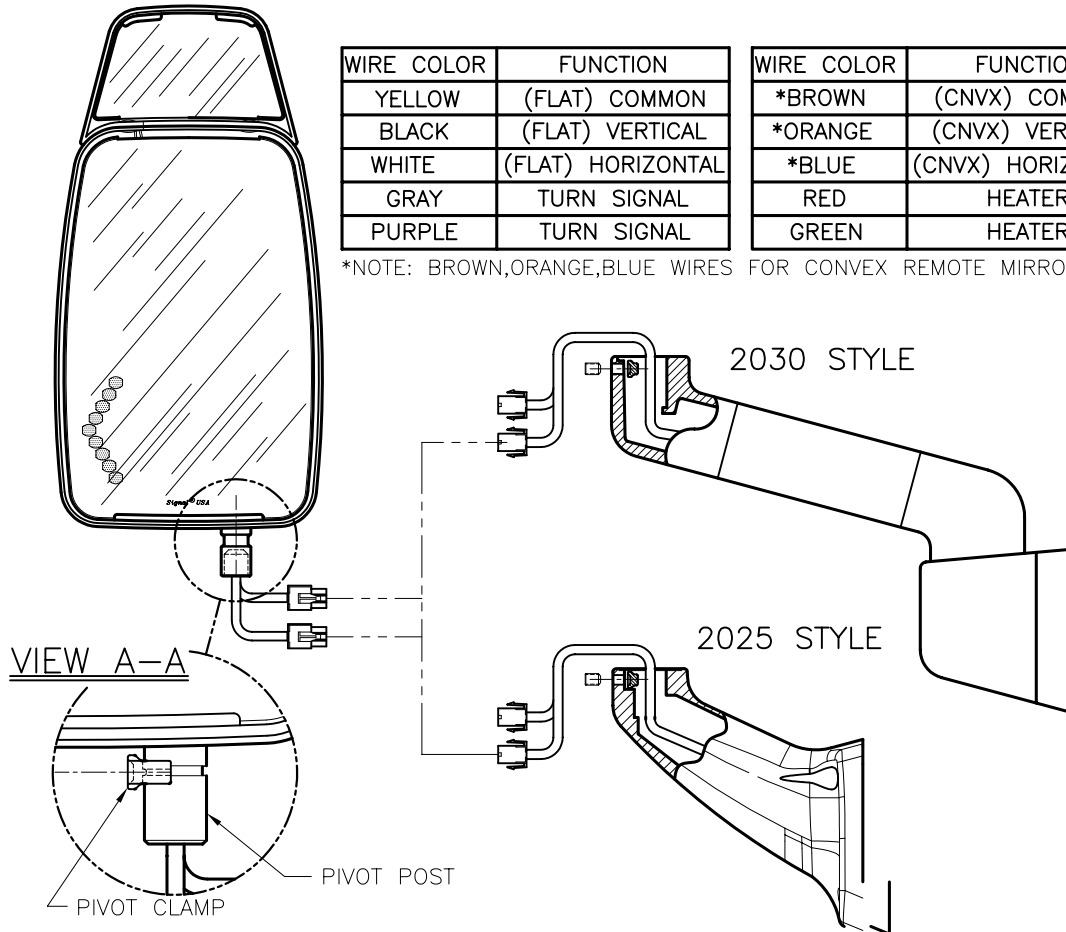

MIRROR ASSEMBLIES WITH ELECTRICAL PLUG

- STEP #1-LOOSEN MIRROR HEAD SET SCREW.
- STEP #2-LIFT MIRROR HEAD FROM MOUNTING BASE/ARM AND REMOVE OLD HEAD BY DISCONNECTING PLUGS. SAVE PIVOT CLAMP TO ATTACH REPLACEMENT HEAD. (SEE VIEW A-A)
- STEP #3-TO MOUNT THE REPLACEMENT MIRROR HEAD. CONNECT THE MALE MIRROR HEAD PLUGS TO THE FEMALE PLUGS ON THE MOUNTING BASE/ARM. (MAKE SURE THE PLUGS ARE ATTACHED PROPERLY BY MATCHING THE WIRE COLORS ON THE MIRROR HEAD TO THE WIRE COLORS ON THE MOUNTING BASE/ARM.) BE SURE TO PLACE CLAMP INTO MIRROR PIVOT POST PRIOR TO POSITIONING MIRROR PIVOT INTO BASE/ARM SEE (VIEW A-A.)
- STEP #4-PIVOT MIRROR HEAD INTO PROPER VIEWING POSITION AND TIGHTEN SET SCREW.

MIRROR ASSEMBLIES WITHOUT ELECTRICAL PLUG

- STEP #1-LOOSEN MIRROR HEAD SET SCREW.
- STEP #2-LIFT MIRROR HEAD FROM MOUNTING BASE/ARM AND REMOVE OLD HEAD BY CUTTING MIRROR HEAD WIRES OFF AS CLOSE TO MIRROR HEAD AS POSSIBLE. SAVE PIVOT CLAMP TO ATTACH REPLACEMENT HEAD. (SEE VIEW A-A)
- STEP #3-CUT PLUGS OFF REPLACEMENT MIRROR HEAD LEAVING AS MUCH WIRE AS POSSIBLE.
- STEP #4-ON BOTH THE REPLACEMENT MIRROR HEAD AND EXISTING MOUNTING BASE/ARM CUT OUTSIDE WIRE JACKET BACK APPROXIMATELY 2-1/2" AND 3-1/2" AS SHOWN. STRIP INDIVIDUAL WIRES BACK 1/4" (SEE VIEW B-B)
- STEP #5-CONNECT REPLACEMENT MIRROR HEAD WIRES TO EXISTING MOUNTING BASE/ARM WIRES USING BUTT CONNECTORS SUPPLIED WITH KIT MATCH WIRE COLORS IN REPLACEMENT MIRROR HEAD WITH WIRES IN MOUNTING BASE/ARM AS SHOWN IN VIEW B-B. PULL ON WIRE CONNECTIONS TO MAKE SURE BUTT CONNECTORS ARE CRIMPED PROPERLY.
- STEP #6-BE SURE TO PLACE CLAMP INTO MIRROR PIVOT POST PRIOR TO POSITIONING MIRROR PIVOT INTO BASE/ARM AS SHOWN IN VIEW A-A.
- STEP #7-PIVOT MIRROR HEAD INTO PROPER VIEWING POSITION AND TIGHTEN SET SCREW.

VELVAC® DRAWN BY: MS
DATE: 02-12-01

INSTALLATION INST. REPLACEMENT
CLASS "A" MIRROR HEAD W/TURN
SIGNAL

PROPRIETARY

SCALE:

DRAWING NO.

7149882

REVISIONS	
ECN #E01046	
▲01	02-12-01 MS
ECN #E04182	
▲CHGD APPEARANCE	OF SIGNAL GLASS
▲2	ADDED NOTES
▲02	04-11-06 BM

FUNCTIONAL REVISIONS:
ALL REVISIONS WITH SOLID
TRIANGLE ARE USABLE

THIS CONCEPT & DRAWING IS THE
PROPERTY OF VELVAC, INC. AND
SHALL NOT BE REPRODUCED,
COPIED, DISCLOSED, USED FOR THE
MANUFACTURE OR PROCUREMENT
FROM SOURCES OTHER THAN
VELVAC INC. WITHOUT WRITTEN
PERMISSION FROM VELVAC INC.