

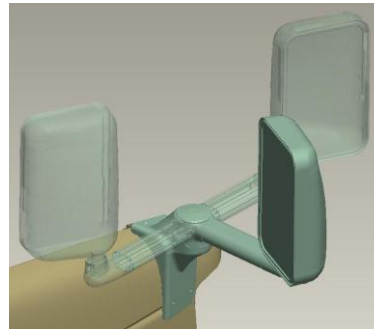

FOR IMMEDIATE RELEASE

Velvac's next generation Shuttle Bus Mirror is more robust, stable and rust-free with a significantly larger field of view, hidden wires, die cast aluminum construction, adjustable home position, OE tested parts, powder coated, foldaway feature and lower overall life costs.



New Berlin, WI (April 12, 2010)- Velvac, Inc. is pleased to announce the introduction of a new 2020SS mirror system for shuttle bus applications. The left side (driver side) door mirror fits directly into the OE "sail" patch area on the door. The right side (passenger side) fender mirror utilizes Velvac's new bracket mount system that attaches easily under the hood for a fast clean installation. The mirror systems are available to fit both GM G Van and Ford E Van Chassis. They are available for both 96" and 102" wide body width applications for a consistent look across a wide range of vehicles.

Velvac's engineers achieved class-leading visibility and glass stability providing a clear image of the blind spots and passing lanes around the vehicle leading to improved safety and faster driver reaction time. The heavy walled die cast construction significantly reduces vibration. The adjustable mirror home position can be customized for vehicle to maximize view. The large 12.5 inch spherical convex glass provides a 40% larger field of view.

A series of innovative construction features enhance the performance and appearance. An E-coat/powder coating prevents rusting. Wires are internally routed providing an OEM appearance and protection of the wires. A spring loaded foldaway pivot with built-in stops eliminates vehicle and mirror damage from truck washes and tight maneuvering. OE tested components are a proven design for reduced warranty claims. Control switch housing is conveniently located on the internal "sail" patch for easy driver access.

Velvac's current 2020 mirror system has been the leading mirror solution for this class of vehicles for many years. That experience was central to the development of the 2020SS mirror. The mirrors are available with a manual Superstar mirror head or a deluxe mirror with independently adjustable flat and convex glass in manual or heated/remote control adjustment options. The deluxe mirror head can also be provided with an integral camera and blinker light in the flat glass. The complete mirror system includes a left side door mirror, right side fender mirror, installation hardware and all necessary switches and wiring.

Velvac is a leading manufacturer and supplier of vision systems and component parts to the recreational, truck and specialty vehicle industries. Velvac has the industry's broadest mirror product offerings, from high volume replacement mirror heads and service parts to unique, proprietary mirror systems. Founded in 1934, Velvac's corporate offices and aftermarket operations are located in New Berlin, Wisconsin. Its complete, state-of-the-art manufacturing facility is located in Reynosa, Mexico.

Velvac is a registered trade name of Velvac, Inc.

FOR ADDITIONAL INFORMATION, PLEASE CONTACT:

Karen Leix
Product Marketing Manager
Velvac, Inc.
2405 South Calhoun Road
New Berlin, WI 53151
(262) 787-7203
kleix@velvac.com

Visit www.velvac.com