

GLASS REPLACEMENT INSTRUCTION

**** READ ALL INSTRUCTIONS FIRST BEFORE PROCEEDING ****

CAUTION: Always wear eye and hand protection when replacing glass.

- 1) Locate appropriate mirror clip depending if your replacing flat glass or convex glass as shown in view A-A.
- 2) Manually rotate mirror glass to better expose mirror clip and pry off clip with small screw driver at both ends of clip as shown below. Discard clip.
- 3) Remove broken glass (if held in with stick pads) by prying out with screw driver being carefull of sharp edges.
- 4) Once glass is removed, unclip heating element wires located at back of glass taking care that wires do not slip back inside of mirror housing.
- 5) Attach heating element wires to new glass and assemble glass into mirror housing being sure that glass is placed under retaining lip at opposite end of mirror clip as shown below.
- 6) Assemble mirror clip (included in kit) to end of glass housing as shown in view C-C by inserting clip into receiver until clip snaps into place.

Note: Mirror glass clips can be removed as described above or if clip retainer is exposed as shown in view B-B, pinch hooks together with needle nose pliers at points indicated by arrows and pull glass clip out. Follow steps 4 thru 6.

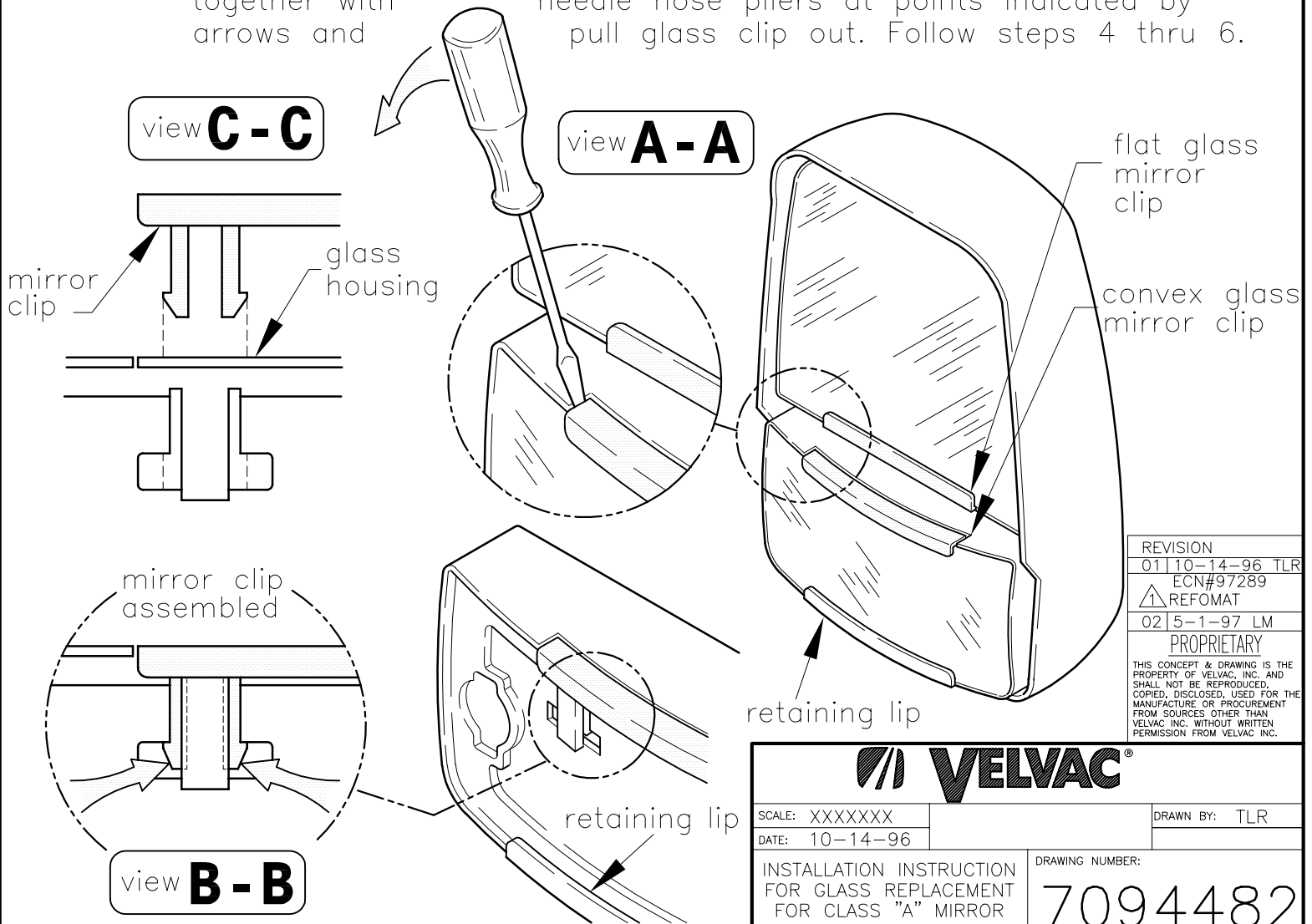

REVISION	
01	10-14-96 TLR
ECN#97289	
1	REFORMAT
02	5-1-97 LM
PROPRIETARY	
THIS CONCEPT & DRAWING IS THE PROPERTY OF VELVAC, INC. AND SHALL NOT BE REPRODUCED, COPIED, DISCLOSED, USED FOR THE MANUFACTURE OR PROCUREMENT FROM SOURCES OTHER THAN VELVAC INC. WITHOUT WRITTEN PERMISSION FROM VELVAC INC.	

VELVAC [®]	
SCALE: XXXXXXXX	DRAWN BY: TLR
DATE: 10-14-96	
INSTALLATION INSTRUCTION FOR GLASS REPLACEMENT FOR CLASS "A" MIRROR	DRAWING NUMBER: 7094482